

KEY:

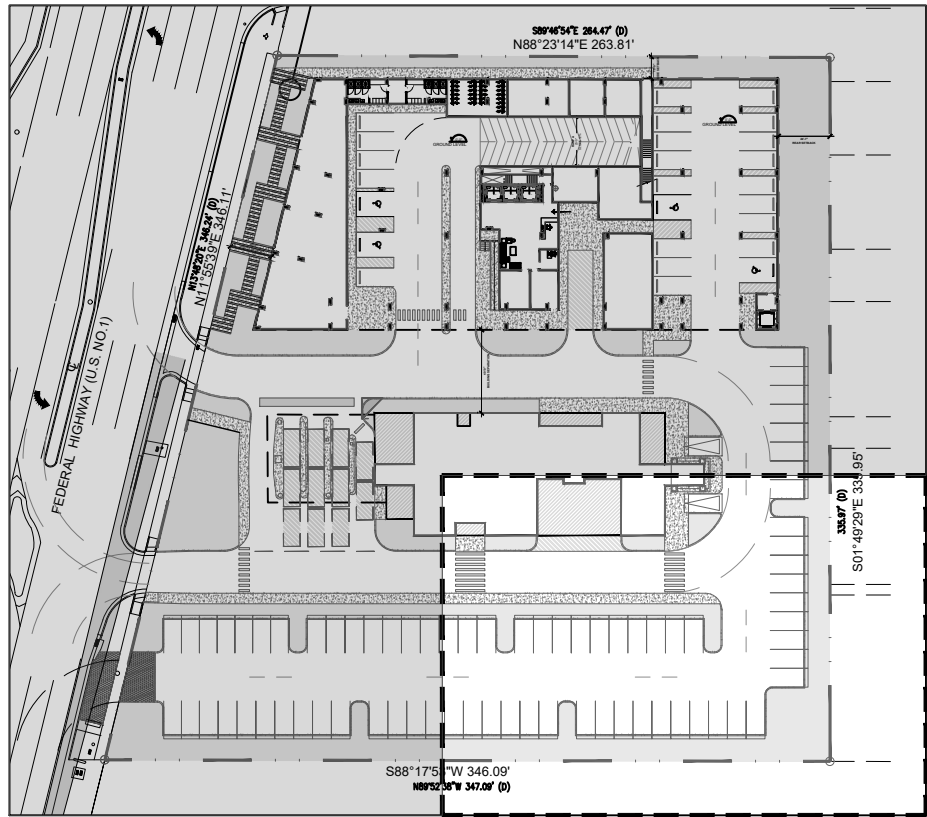

absolute-idea.com
CANAL PARK
3323 NE 163rd Street, Suite 200 North Miami Beach, FL 33160
305.792.0015 305.931.0279 info@absolute-idea.com

SEAL
KEN GARDNER
FLA 1589
TO THE BEST OF MY KNOWLEDGE, THE PLANS AND SPECIFICATIONS COMPLY WITH THE CITY OF MIAMI STANDARDS AND ORDINANCES AND THE PROFESSIONAL SEAL IS VALID FOR THE PROJECT AND SITE SPECIFICALLY DESCRIBED HEREIN.

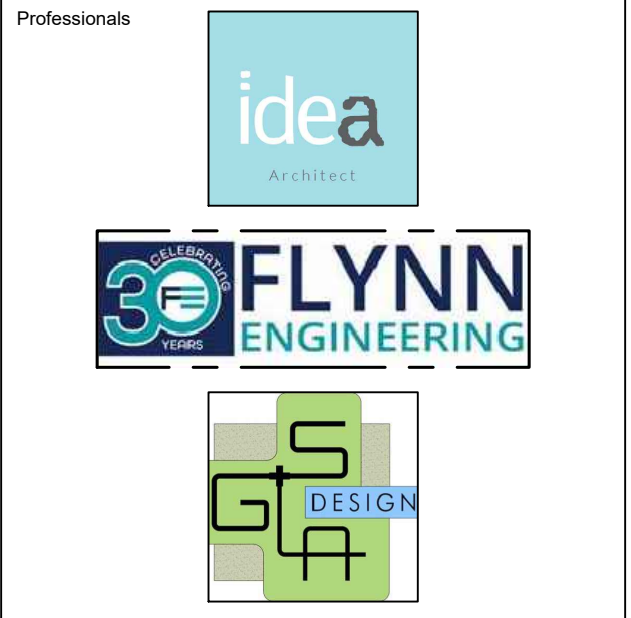

REV.	DATE	DESCRIPTION
01	XX-XX-2024	D.R.C SUBMITAL

ALL MEASUREMENTS MUST BE VERIFIED BEFORE BEGINNING THE WORKS. NO MEASUREMENTS ARE TO BE SCALED DIRECTLY FROM THIS DRAWING.

Key section
PROGRESS SET

Client
VERA FUND
NICK POLYUSHKIN
& YURI KHARITONENKOV
TEL: 305.833.3303

Project
**1600 S FEDERAL HIGHWAY
(MIXED-USE PROJECT)**
1600 SOUTH FEDERAL HIGHWAY,
POMPANO BEACH, FL 33062

Title	
PLANTING PLAN GROUND FLOOR	
Drawn GSLA KG KG	Field LANDSCAPE ARCH as shown 10-09-2024 1204 24-838
Project Manager 11/19/2025 24-838	
Sheet no. L-204	

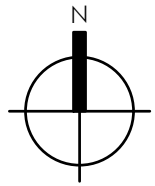

PLANTING PLAN - GROUND FLOOR
SCALE: 1" = 10'